

DIGITAL CADASTRAL DATA BASE - BOUNDARY INFORMATION.
 Based on or contains data provided by the State of Queensland (Department of Natural Resources and Mines) [2 June 2018]. In consideration of the State permitting use of this data you acknowledge and agree that the State gives no warranty in relation to the data (including accuracy, reliability, completeness, currency or suitability) and accepts no liability (including without limitation, liability in negligence) for any loss, damage or costs (including consequential damage) relating to any use of the data. Data must not be used for direct marketing or be used in breach of the privacy laws.
 © State of Queensland (Department of Natural Resource & Mines) [2018]

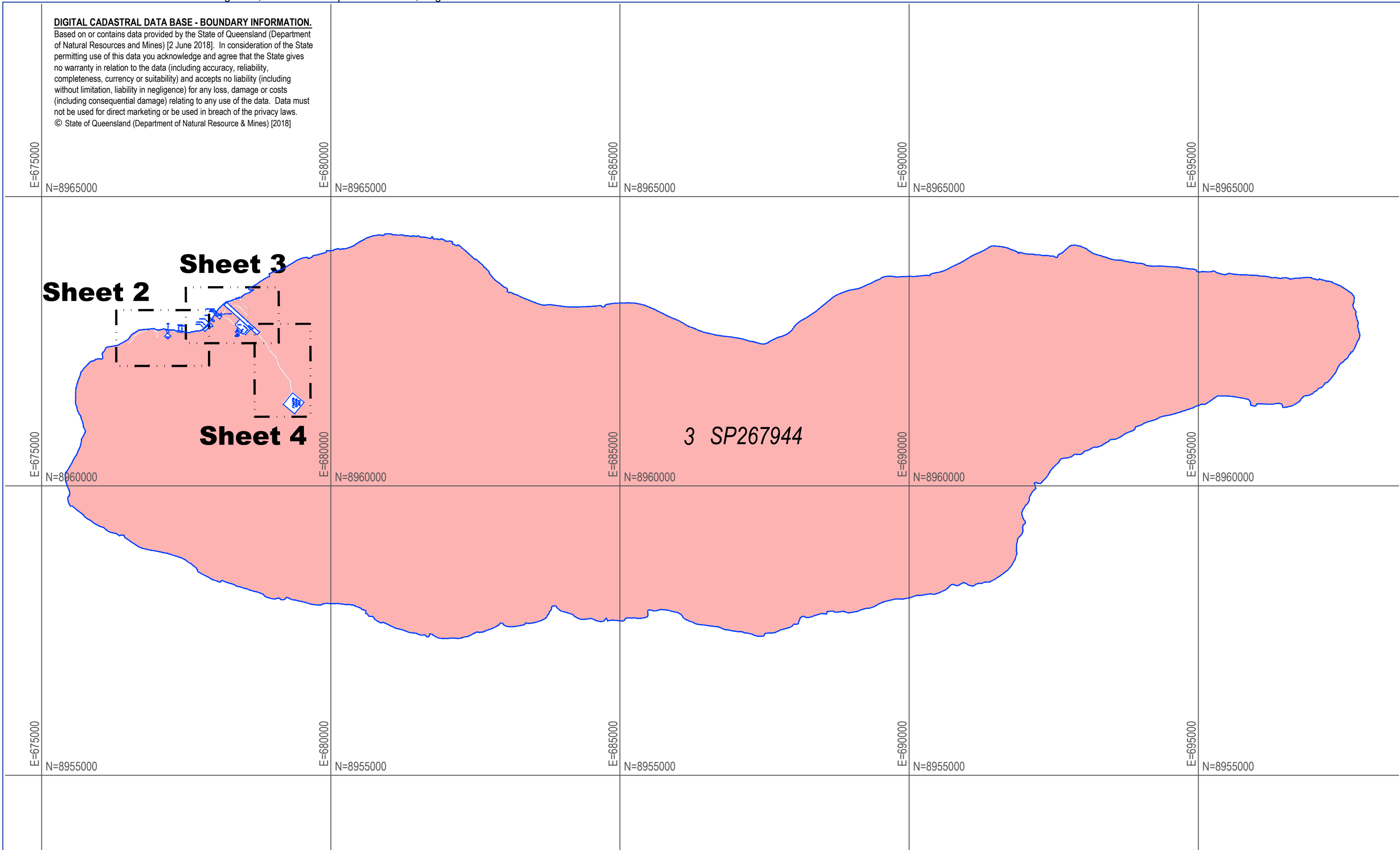

Schedule 3 - Mapping Saibai Infrastructure and Housing ILUA

LEGEND

- ILUA Area
- Native Title Determination

1 SP267944 Lotno PlanNumber DCDB 2 June 2018



RPS Australia East Pty Ltd
 ACN 140 292 762
 135 Abbott St
 PO Box 1949
 CAIRNS QLD 4870

T +61 7 4031 1336 F +61 7 4031 2942 W rpsgroup.com.au

0 700 1400 2100 2800 3500 7000

N=8963000

N=8963000

N=8963000

N=8963000

E=676500

E=677000

E=677500

DIGITAL CADASTRAL DATA BASE - BOUNDARY INFORMATION.

Based on or contains data provided by the State of Queensland (Department of Natural Resources and Mines) [2 June 2018]. In consideration of the State permitting use of this data you acknowledge and agree that the State gives no warranty in relation to the data (including accuracy, reliability, completeness, currency or suitability) and accepts no liability (including without limitation, liability in negligence) for any loss, damage or costs (including consequential damage) relating to any use of the data. Data must not be used for direct marketing or be used in breach of the privacy laws.
© State of Queensland (Department of Natural Resource & Mines) [2018]

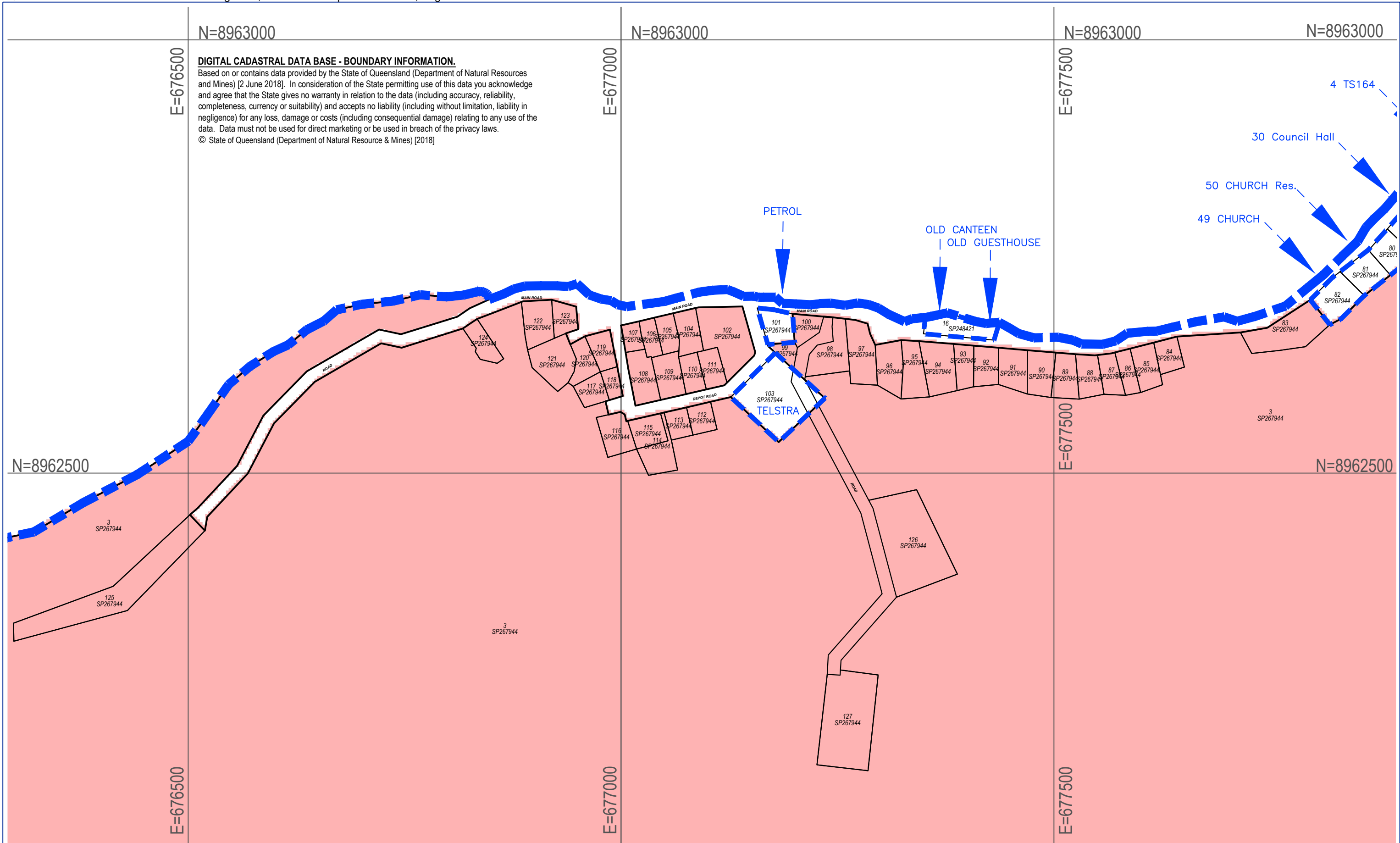

N=8962500

N=8962500

E=676500

E=677000

E=677500



Schedule 3 - Mapping Saibai Infrastructure and Housing ILUA Saibai Village

LEGEND

- ILUA Area
- Native Title Determination



RPS Australia East Pty Ltd
ACN 140 292 762
135 Abbott St
PO Box 1949
CAIRNS QLD 4870

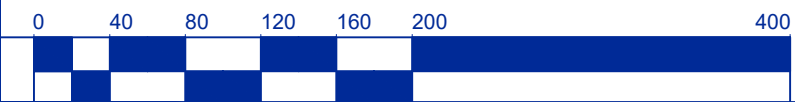

1 SP267944 Lotno PlanNumber DCDB 2 June 2018

T +61 7 4031 1336 F +61 7 4031 2942 W rpsgroup.com.au

DIGITAL CADASTRAL DATA BASE - BOUNDARY INFORMATION.

Based on or contains data provided by the State of Queensland (Department of Natural Resources and Mines) [2 June 2018]. In consideration of the State permitting use of this data you acknowledge and agree that the State gives no warranty in relation to the data (including accuracy, reliability, completeness, currency or suitability) and accepts no liability (including without limitation, liability in negligence) for any loss, damage or costs (including consequential damage) relating to any use of the data. Data must not be used for direct marketing or be used in breach of the privacy laws.
 © State of Queensland (Department of Natural Resource & Mines) [2018]

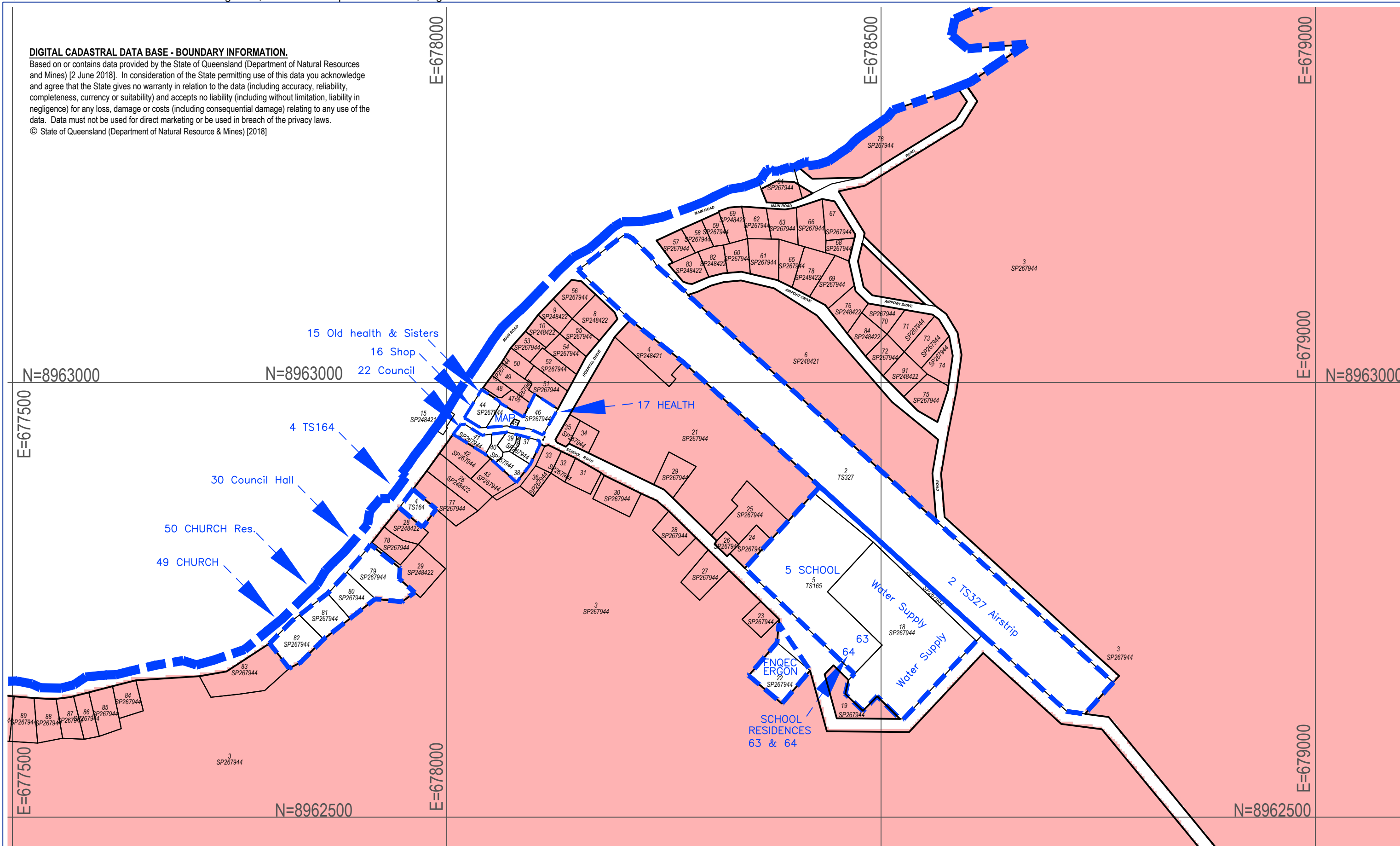

Schedule 3 - Mapping Saibai Infrastructure and Housing ILUA Saibai Village

LEGEND

- ILUA Area
- Native Title Determination

1 SP267944 Lotno PlanNumber DCDB 2 June 2018

RPS

RPS Australia East Pty Ltd
 ACN 140 292 762
 135 Abbott St
 PO Box 1949
 CAIRNS QLD 4870

T +61 7 4031 1336 F +61 7 4031 2942 W rpsgroup.com.au

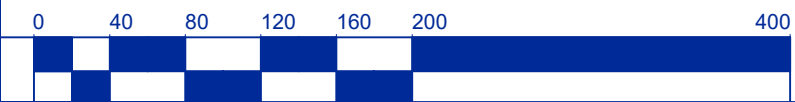

DIGITAL CADASTRAL DATA BASE - BOUNDARY INFORMATION.
 Based on or contains data provided by the State of Queensland (Department of Natural Resources and Mines) [2 June 2018]. In consideration of the State permitting use of this data you acknowledge and agree that the State gives no warranty in relation to the data (including accuracy, reliability, completeness, currency or suitability) and accepts no liability (including without limitation, liability in negligence) for any loss, damage or costs (including consequential damage) relating to any use of the data. Data must not be used for direct marketing or be used in breach of the privacy laws.
 © State of Queensland (Department of Natural Resource & Mines) [2018]

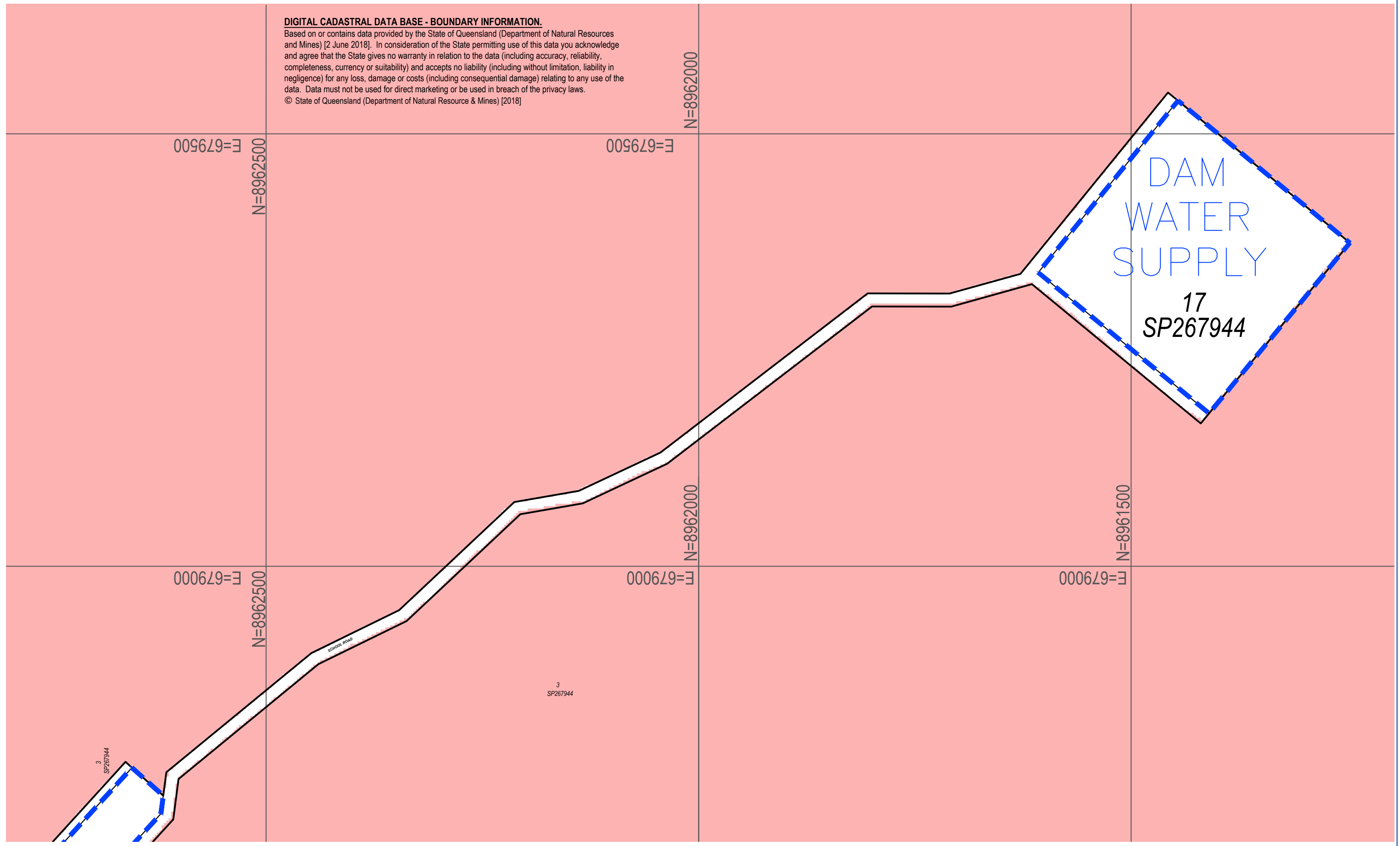

Schedule 3 - Mapping Saibai Infrastructure and Housing ILUA Saibai Water

LEGEND

- ILUA Area
- Native Title Determination



RPS Australia East Pty Ltd
 ACN 140 292 762
 135 Abbott St
 PO Box 1949
 CAIRNS QLD 4870

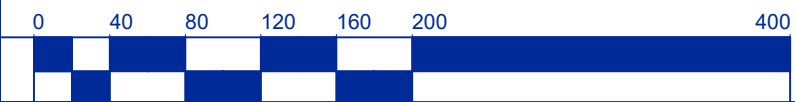

1 SP267944 Lotno PlanNumber DCDB 2 June 2018

T +61 7 4031 1336 F +61 7 4031 2942 W rpsgroup.com.au